

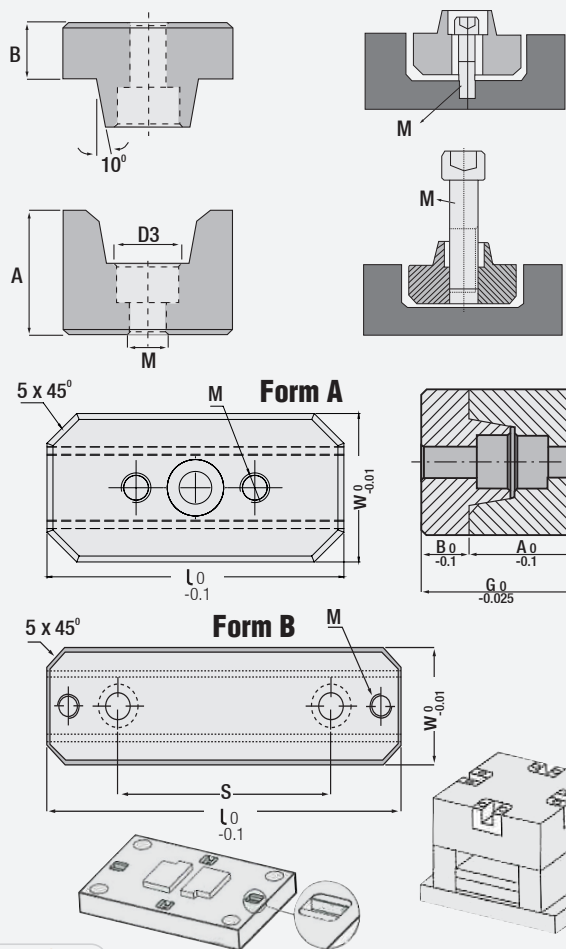

Locating - Centring Unit

Code: **G132**



Code: **G132**

W	L	A	B	G	S	D3	M	Form
25	50	17.5	8	25.5	-	9.6	M5	A
30	100	22	10	32	60	11	M6	
40	150	25	13	38	100	14	M8	

 Order: **G132.W**

Material: 1.2510
Hardness: 52 - 54 HRC



Oil grooves were created on the working surfaces of the products.

Locating - Centring Unit

Code: **G129**

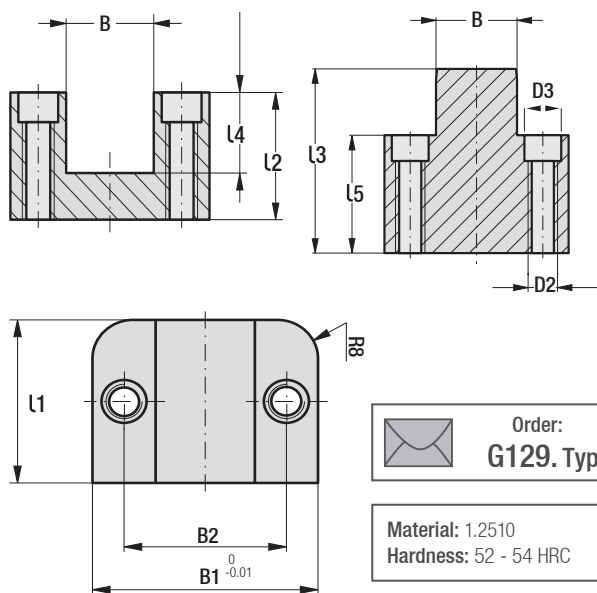

 Order: **G129.Type**

Material: 1.2510
Hardness: 52 - 54 HRC

Code: **G129**

Type	B	B1	B2	L1	L2	L3	L4	L5	D3	D2
1	12.7	38.1	25.5	25.4	22.2	22	13.3	9.5	9	M6
2	25.5	63.5	44.5	38.1	34.9	34.8	19.5	15.9	11	M8
3	36.6	88.9	63.5	50.8	44.5	44.2	25.7	19	18	M12

Note: This product is not suitable for the rotational (multi component) moulds. Please use "G131" products for the rotational multi component moulds.

Mounting Example

